

CAUTION: NO INVESTIGATION OR TESTING HAS BEEN UNDERTAKEN TO DETERMINE THE PRESENCE OF HAZARDOUS MATERIALS ON THE SITE. THE CONTRACTOR SHALL EXERCISE DUE CAUTION REGARDING POTENTIAL CONTAMINATION.

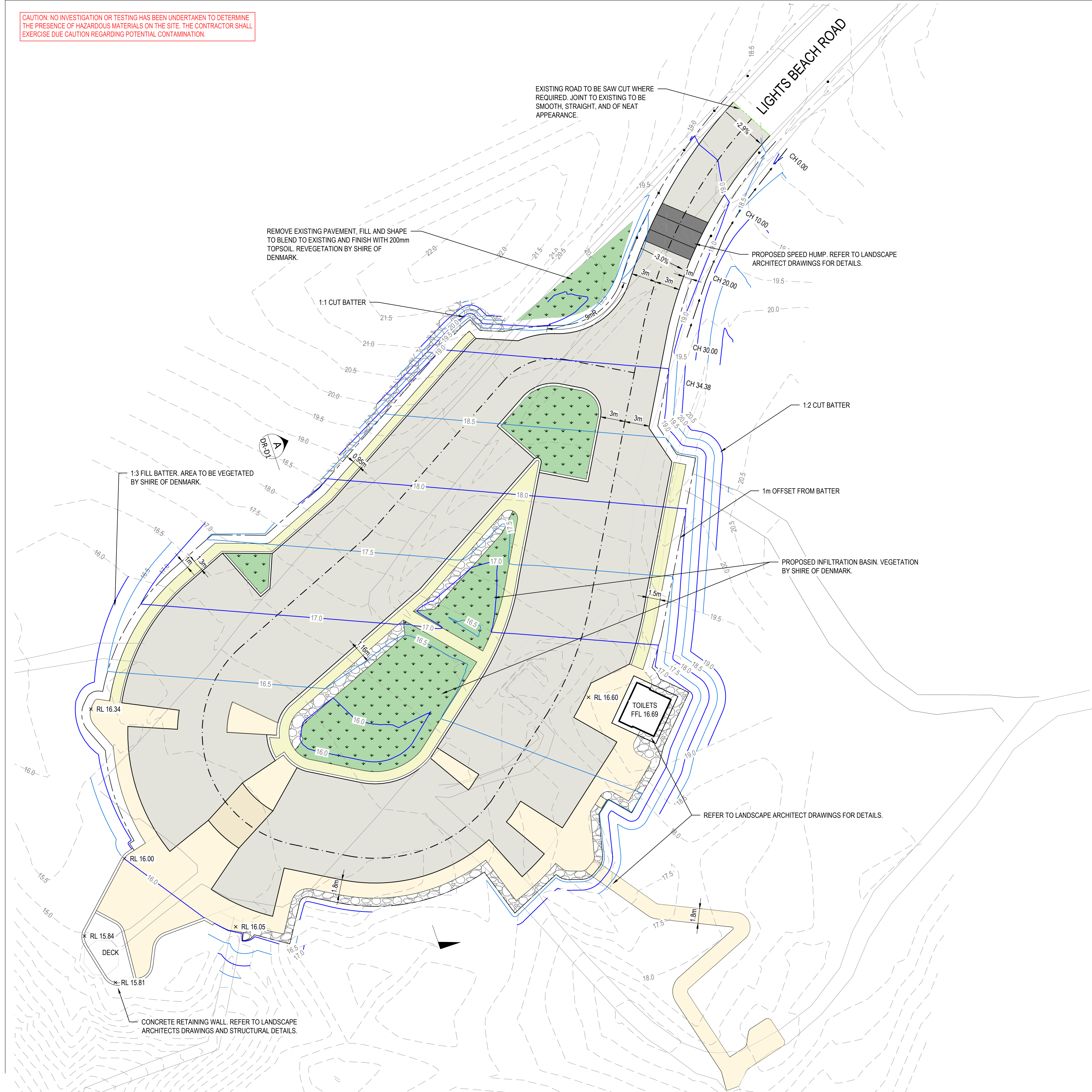

- GENERAL
 - LEVELS ARE REDUCED FROM A.H.D.
 - THIS DRAWING SHALL BE READ IN CONJUNCTION WITH LANDSCAPE ARCHITECTURE DRAWINGS AND SPECIFICATIONS.
- CLEARING
 - THE CONTRACTOR SHALL LIMIT THE MOVEMENT OF EQUIPMENT AND MANPOWER TO THE MINIMUM AREA NECESSARY AND PROTECT ALL VEGETATION ON SITE.
 - THE CONTRACTOR SHALL CLEAR VEGETATION AND DEBRIS FROM WITHIN THE SITE BOUNDARY IN ACCORDANCE WITH THE SPECIFICATION.
- EXISTING SERVICES
 - THE CONTRACTOR SHALL ALLOW TO PROTECT AND RELOCATE EXISTING SERVICES AND COVERS AS REQUESTED OR AS NECESSARY.
 - THE CONTRACTOR SHALL ADJUST ALL KNOWN SERVICES PITS, LIDS AND METERS TO SUIT FINISHED LEVEL. COSTS TO BE BORNE BY THE CONTRACTOR.
- EARTHWORKS
 - CONTRACTOR SHALL STRIP AND REMOVE FROM SITE EXCESS TOPSOIL.
 - THE CONTRACTOR SHALL CUT, PROOF ROLL, AND FILL SITE IN ACCORDANCE WITH THE SPECIFICATION.
 - 1:1 CUT BATTERS TO BE STABILISED WITH ROCK PITCHING (UNMORTARED 100mm NOMINAL DIAMETER GRANITE).
 - 1:2 CUT BATTERS TO BE STABILISED WITH REVEGETATION AND JUTE MATTING AS PER DOCUMENTATION.
 - FILL BATTERS TO BE 1:3 AND STABILISED WITH REVEGETATION AND MULCHING/BRUSHING AS PER DOCUMENTATION.
- ROADWORKS
 - PAVEMENT WIDTH SHALL BE AS SHOWN ON THE DRAWING AND SHALL BE MEASURED BETWEEN KERBS AND EDGE OF SEAL.
- TOPSOIL
 - TOPSOIL SHALL BE STRIPPED FROM THE SITE AS SPECIFIED.
 - THE CONTRACTOR SHALL STOCKPILE TOPSOIL ON SITE FOR FUTURE RE-USE.
 - TOPSOIL SHALL BE RE-SPREAD TO BATTERS, INFILTRATION BASINS AND OTHER DISTURBED AREAS AS DIRECTED BY THE LANDSCAPE ARCHITECT. THICKNESS TO BE 100-200mm UNLESS ADVISED OTHERWISE.
 - NO WEED, OR WEED SEED, CONTAINING TOPSOIL MATERIAL. SHALL BE RE-SPREAD ON THE SITE.
- STAGING, SITE ACCESS AND PROTECTION
 - STAGING, SITE ACCESS AND HAULAGE ROUTES SHALL BE AGREED WITH THE SHIRE OF DENMARK PRIOR TO WORKS COMMENCING.
 - TRAFFIC AND PEDESTRIAN MANAGEMENT SHALL BE PROVIDED BY THE CONTRACTOR AND APPROVED BY THE SHIRE OF DENMARK PRIOR TO WORKS COMMENCING.

LEGEND

- EXISTING CONTOURS.
- DESIGN CONTOURS.
- SPOT HEIGHT
- PROPOSED FLUSH KERB.
- PROPOSED ROAD CENTRELIN.
- PROPOSED EDGE OF BITUMEN.
- PROPOSED OPEN DRAIN.
- PROPOSED SHOULDER.
- EXISTING ROAD AND FEATURES.
- EXISTING OPEN DRAIN.
- PROPOSED SAWCUT LINE.
- CONCRETE PATH. REFER TO LANDSCAPE ARCHITECT'S DOCUMENTATION FOR DETAIL.
- COMPACTED LIMESTONE PATH. REFER TO LANDSCAPE ARCHITECT'S DOCUMENTATION FOR DETAIL.
- LANDSCAPE AREA. REFER TO LANDSCAPE ARCHITECT'S DOCUMENTATION FOR DETAIL. REVEGETATION BY SHIRE OF DENMARK.
- PROPOSED ASPHALT PAVEMENT 25mm AC10 (BLACK).
- PROPOSED GRANITE ROCK PITCHING OVER A12BIDIM DRAIN. REFER TO SPECIFICATION.
- PROPOSED GUIDEPOST LOCATION.
- PROPOSED BOLLARDS. REFER TO LANDSCAPE ARCHITECT'S DOCUMENTATION FOR DETAIL.
- PROPOSED 600mm TIMBER BOLLARDS. REFER TO LANDSCAPE ARCHITECT'S DOCUMENTATION FOR DETAIL.

1:250 2.5 0 2.5 5 7.5 10 12.5 A1
1:500 A3

THIS DRAWING HAS BEEN DOCUMENTED IN COLOUR.
THIS DRAWING IS REQUIRED TO BE PRINTED IN COLOUR.
FAILURE TO DO SO MAY RESULT IN LOSS OF INFORMATION.
BLACK & WHITE PRINTING MAY ONLY BE USED IF SPECIFIC BLACK & WHITE
DOCUMENTS HAVE BEEN OBTAINED FROM STANTEC.



REV	DESCRIPTION	DRAWN	APPD	DATE
A	ISSUED FOR TENDER	JD	FW	09/09/2020



LIGHTS BEACH UPGRADE
ROAD PLAN

PROJECT/TITLE



TENDER ISSUE
NOT FOR CONSTRUCTION
CIVIL

MGA	mAHD	1:250	301248187 CI-400-RD-P1	A
COORDS	DATUM	SCALE @ A1	PROJECT No	DRAWING No