



[White box]

Denmark  
Primary  
School

Ocean Beach Rd

Buckley St

Clarke Ct

Portions of  
Reserve 45473

Kingdon  
Park

Reserve  
37702

Lot 9003 (#16)  
Honeymyrtle Cct

Lot 672 (#15)  
Zimmerman St

Hopson  
Park

Matthews Pl

Honeymyrtle Cct

Shire  
Depot

Zimmerman St

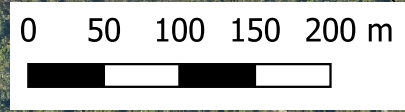



Clarke Close

Lot 1088 (Kingdon Park)  
Part of Reserve 45473

Reserve  
37702

Ocean Beach Rd

Lot 9003 (#16)  
Honeymyrtle Cct

Lot 301  
Part of Reserve 45473

Lot 672 (#15)  
Zimmerman St

Lot 302  
Part of Reserve 45473

Matthews Pl

Honeymyrtle Cct

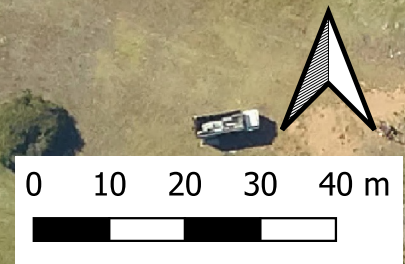



[Redacted]

Clarke Close

Proposed Reserve 45473  
(drainage/ access)

Reserve 37702

Proposed Lot 9003  
(private landholding)

Proposed Reserve 45473

Proposed Reserve 45473

Lot 672 (#15)  
Zimmerman St

Ocean Beach Rd

Matthews Pl

Honeymyrtle Cct

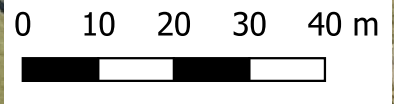

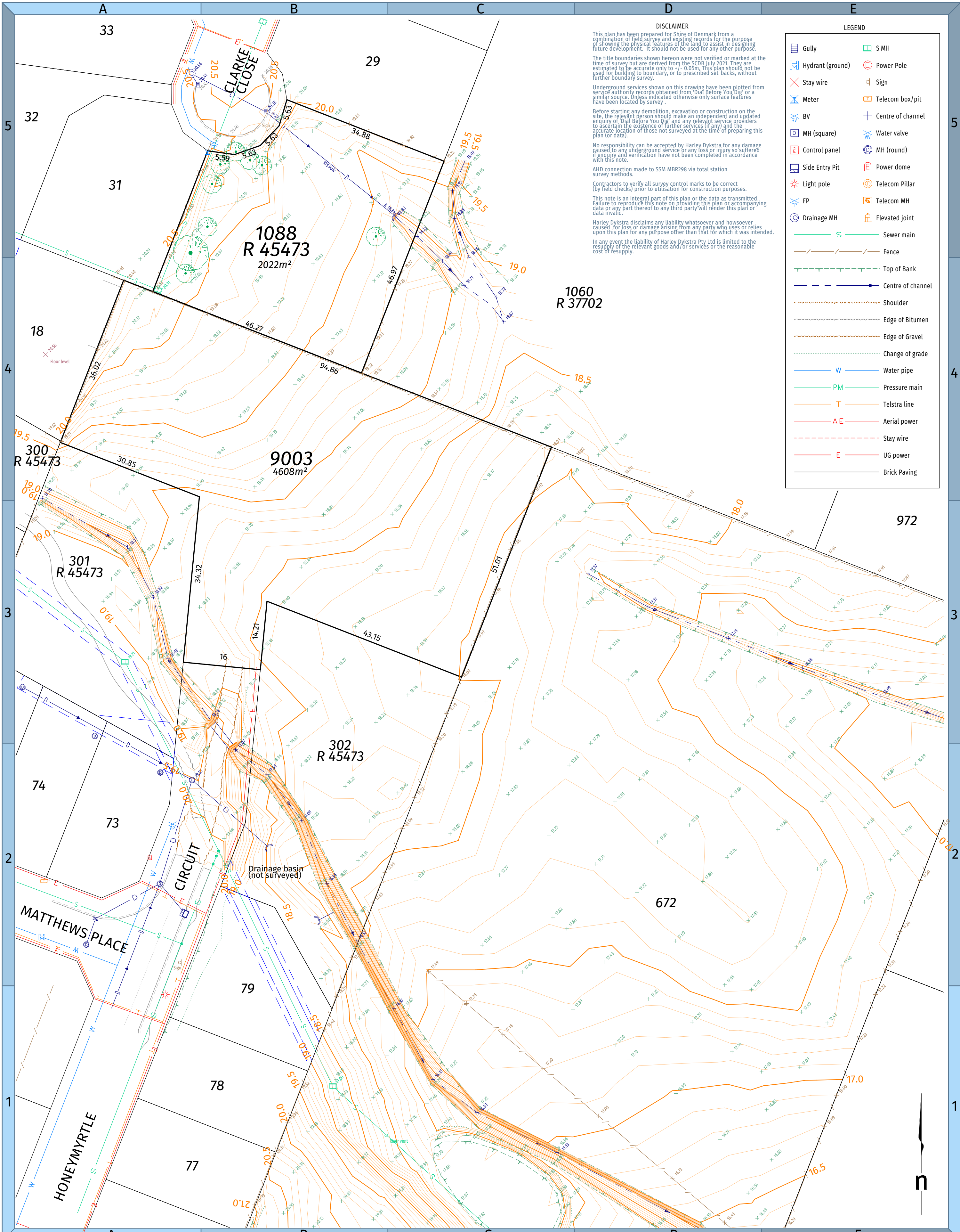

**DISCLAIMER**

This plan has been prepared for Shire of Denmark from a combination of field survey and existing records for the purpose of showing the physical features of the land to assist in designing future development. It should not be used for any other purpose.

The title boundaries shown hereon were not verified or marked at the time of survey but are derived from the SCDB July 2021. They are estimated to be accurate only to +/- 0.05m. This plan should not be used for building to boundary, or to prescribed set-backs, without further boundary survey.

Underground services shown on this drawing have been plotted from service authority records obtained from 'Dial Before You Dig' or a similar source. Unless indicated otherwise only surface features have been located by survey.

Before starting any demolition, excavation or construction on the site, the relevant person should make an independent and updated enquiry of 'Dial Before You Dig' and any relevant service providers to ascertain the existence of further services (if any) and the accurate location of those not surveyed at the time of preparing this plan (or data).

No responsibility can be accepted by Harley Dykstra for any damage caused to any underground service or any loss or injury so suffered if enquiry and verification have not been completed in accordance with this note.

AHD connection made to SSM MBR298 via total station survey methods.

Contractors to verify all survey control marks to be correct (by field checks) prior to utilisation for construction purposes.

This note is an integral part of this plan or the data as transmitted. Failure to reproduce this note on providing this plan or accompanying data or any part thereof to any third party will render this plan or data invalid.

Harley Dykstra disclaims any liability whatsoever and howsoever caused for loss or damage arising from any party who uses or relies upon this plan for any purpose other than that for which it was intended.

In any event the liability of Harley Dykstra Pty Ltd is limited to the resupply of the relevant goods and/or services or the reasonable cost of resupply.

**LEGEND**

	Gully		S MH
	Hydrant (ground)		Power Pole
	Stay wire		Sign
	Meter		Telecom box/pit
	BV		Centre of channel
	MH (square)		Water valve
	Control panel		MH (round)
	Side Entry Pit		Power dome
	Light pole		Telecom Pillar
	FP		Telecom MH
	Drainage MH		Elevated joint
	Sewer main		Fence
	Top of Bank		Centre of channel
	Shoulder		Edge of Bitumen
	Edge of Gravel		Change of grade
	Water pipe		Water pipe
	Pressure main		Pressure main
	Telstra line		Telstra line
	Aerial power		Aerial power
	Stay wire		Stay wire
	UG power		UG power
	Brick Paving		Brick Paving

ALBANY OFFICE:  
 HARLEY DYKSTRA PTY LTD  
 31 Albany Highway, ALBANY WA 6330  
 T: 08 9844 5100  
 E: albany@harleydykstra.com.au  
 W: www.harleydykstra.com.au

ALBANY | DENMARK | BUNBURY | BUSSELTON | FORRESTDALE | PERTH

**NOTE:**  
 This drawing is the property of harley dykstra pty ltd it may not be copied or altered without the consent of the owner

scale at A2  
 all distances are in metres  
 1 : 500

description	Lot 9003 Honeymyrtle Circuit & Lot 1088 Clarke Close Denmark
client	Shire of Denmark
drawing no	23538-01A
plan type	Feature Survey
rev	A
details	Original drawing
approved	AJE
date	7-12-22
survey	AJE 7-12-2022
cad file	23538-01A.lcd
drawn	AJE 7-12-2022
checked	SD 7-12-2022
horiz datum	MORLEY94
level datum	AHD



## SCHEDULE OF SUBMISSIONS

### Preliminary Referral to Servicing Agencies

#### Proposed Land Exchange – Realignment of boundaries between Reserve 45473 and adjoining Lot 9003 (No. 16) Honeymyrtle Circuit

Ref No.	Submitter	Verbatim Submission	Planning Services Comment
1	Water Corporation	<p>The Water Corporation has no concerns with the proposed land exchange.</p> <p>There is a 150mm diameter PVC gravity sewer running along (inside) the western boundary of Lot 1088. This sewer is part of the local sewer network that services houses in the area. At this stage there is no need to establish an easement over the sewer as it is already afforded protection under the powers of the <i>Water Services Act</i> and Regulations. The sewer cannot be built over and any future subdivision of this portion of Lot 1088 will need to accommodate the sewer in place.</p> <p>Under the land exchange circumstances described in your email, it is unlikely that an application to amalgamate these portions into one lot would attract any servicing conditions. However, this is a matter for the WAPC to determine at the application stage and the proponent should be advised to address this issue in their supporting information submitted with the application.</p>	Noted.
2	Western Power	<p>Having done a desk top review of your submission, Western Power does not have any objection at this time to the proposed land exchange between Reserve 45473 and Lot 9033 Honeymyrtle Circuit and there are no identifiable assets that would be encroached by the proposed.</p> <p>If further information is required, a project will need to be submitted via a website to perform a detailed assessment.</p>	Noted.
3	Telstra	No response received.	Presume no objection to proposed land exchange. No known telecommunications infrastructure within either public or private land subject of this proposal.