



| | |
|-----------------------|------|
| Shire of Denmark | |
| ICR1082504 | |
| 17 AUG 2010 | |
| R 30132 | |
| DATE | LEP# |
| FILE REF | |
| COUNCILLORS | |
| CEO | |
| DIR of FINANCE | R |
| DIR of PLANNING | |
| DIR of INFRASTRUCTURE | ✓ |
| DIR of COMMUNITY | |
| OTHER | |

9 August 2010

Chief Executive Officer
Shire of Denmark
953 South Coast Highway
DENMARK WA 6333

Dear Sir

REQUEST TO CLOSE PORTION OF BUSH ROAD ADJACENT TO LOT 1716, TINGLEDAL

The owner of Lot 1716 Bush Road Tingledale, Mr G Townley is seeking the Council's approval for the closure of the portion of Bush Road, Tingledale. The subject portion of Bush Road that Mr Townley is seeking to close is located adjacent to his land as shown on the attached plan.

As can be seen from the plan, Bush Road is a cul-de-sac ending at the north eastern corner of Mr Townley's property. This section of road is not required for access to any other land in the area. The adjacent property to the south (Lot 1717) is served by Settlers Boundary Road and does not require Bush Road for access. In addition, Lot 34 located on the eastern side of Bush Road also does not require this section of Bush Road for access.

This section of Bush Road has only been developed to a "track" status and serves no purpose to Lot 1716 or any of the adjoining lots. Photographs of the existing track are attached. The closure of this section of road will remove the management burden from the council and enable the land to be put to effective agricultural use.

Mr Townley has discussed this proposal with all adjoining neighbours, who have all raised no objection for the road to be closed and included into Lot 1716. We understand that once the Council has approved the proposed road closure, the request will be forwarded to State Lands to arrange for the sale and transfer of the land.

Please find attached a cheque for \$200.00 being the Shire of Denmark application fee for road closure. Please do not hesitate to contact either Mr Townley on 418 906 405 or myself should you require further information.

Yours sincerely

Eugene Ferraro
Director

CHO Sent to tech Services.

Attachment 8.3.2

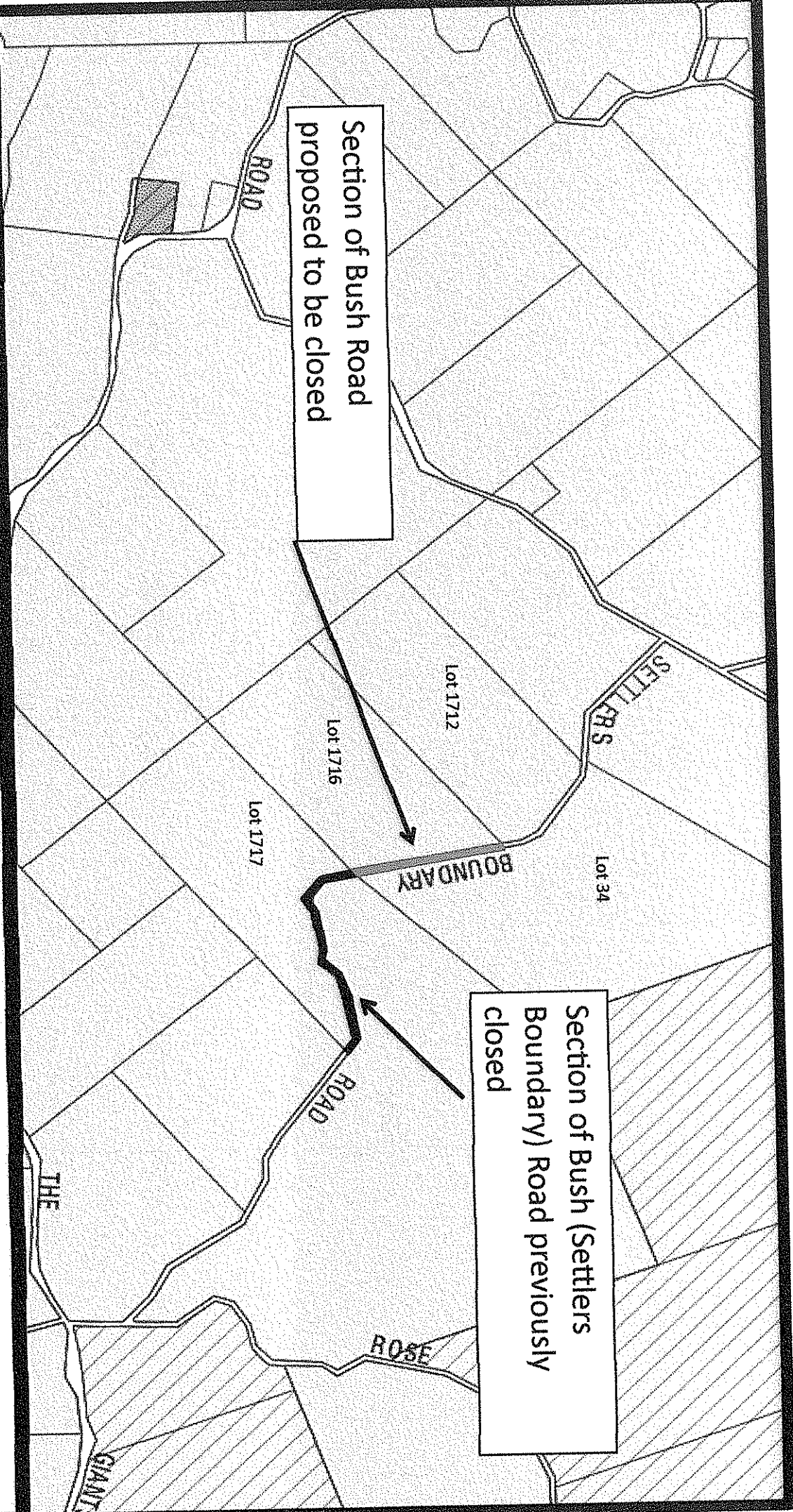

Section of Bush Road
proposed to be closed

Section of Bush (Settlers
Boundary) Road previously
closed

PROPOSED CLOSURE OF PORTION OF BUSH ROAD

TINGLEDALE

SHIRE OF DENMARK

CLIENT G TOWNLEY

Not to Scale

AUGUST 2010



Ferraro planning and development consultancy

U210/396 Scarborough Beach Road Osborne Park WA 6017

PO Box 1563 MELVILLE SOUTH WA 6157

Nikagen Pty Ltd as Trustee for Ferraro Family Trust ACN 139 854 621



fpcdc

Ferraro planning and development consultancy

U210/396 Scarborough Beach Road Osborne Park WA 6017

PO Box 1563 MELVILLE SOUTH WA 6157

Nikogem Pty Ltd as Trustee for Ferraro Family Trust ACN 139 854 621

**EXISTING TRACK ON BUSH ROAD
TINGLEDALE**

SHIRE OF DENMARK

CLIENT G TOWNLEY

AUGUST 2010

