



Produced by Shire of Denmark.
 Whilst all care has been taken, no responsibility shall be taken for any omissions or errors in this documentation.
 Please advise the Shire of Denmark of any errors or omissions in this document.
 Digital Cadastral Data Supplied by the Western Australian Land Information Authority.

LIGHTS BEACH DEVELOPMENT CONCEPT PLAN
DRAFT ONLY

0 25 50 Meters

Scale 1:500 @ A1

16 JUNE 2020 - ATTACHMENT 8.1.1(b)

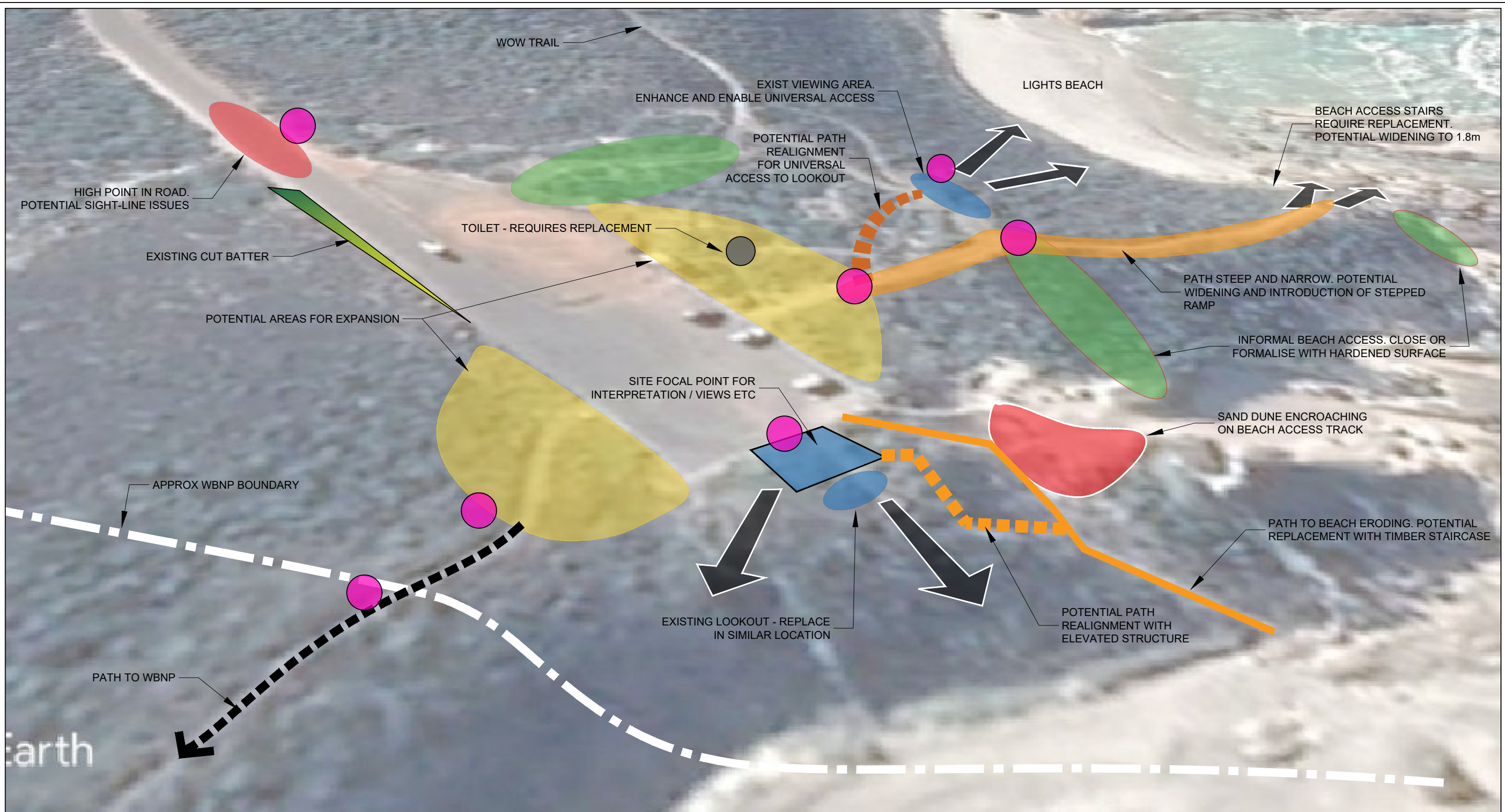

- POTENTIAL AREAS FOR CAR PARK EXPANSION
- EXISTING AND POTENTIAL VIEWING AREAS
- DEGRADED AREAS. FORMALISE OR CLOSE AND REHAB.
- AREAS REQUIRING PATH RECTIFICATION / UPGRADES
- POTENTIAL UNIVERSAL ACCESS
- POTENTIAL PATH REALIGNMENT
- POTENTIAL SIGNAGE LOCATIONS

site analysis



1 OF 6
JUNE 2020

DRAFT
FOR DISCUSSION ONLY



Prepared for the
Shire of Denmark

LIGHTS BEACH REDEVELOPMENT concept plan

DRUM
landscape architecture

Doug Simpson
0434 229 122 / dougdrum68@gmail.com



EXTENT OF POTENTIAL EXPANSION AREAS



PROPOSED CAR PARK OVERLAY

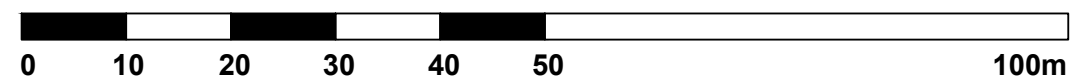

EXISTING CONDITIONS

DRAFT
FOR DISCUSSION ONLY

Prepared for the
Shire of Denmark



LIGHTS BEACH REDEVELOPMENT concept plan

DRUM
landscape architecture

Doug Simpson
0434 229 122 / dougdrum68@gmail.com

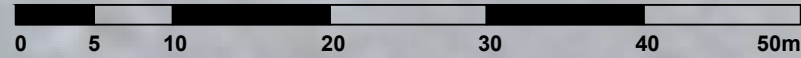

NOTE:
 BASE INFORMATION FOR PLANS TAKEN FROM
 AERIAL PHOTOGRAPHY ONLY. FOR FURTHER DETAIL
 AND CONFIRMATION OF LAYOUT, A FEATURE SURVEY
 IS REQUIRED.

REFER SHEET 4 FOR DETAILS

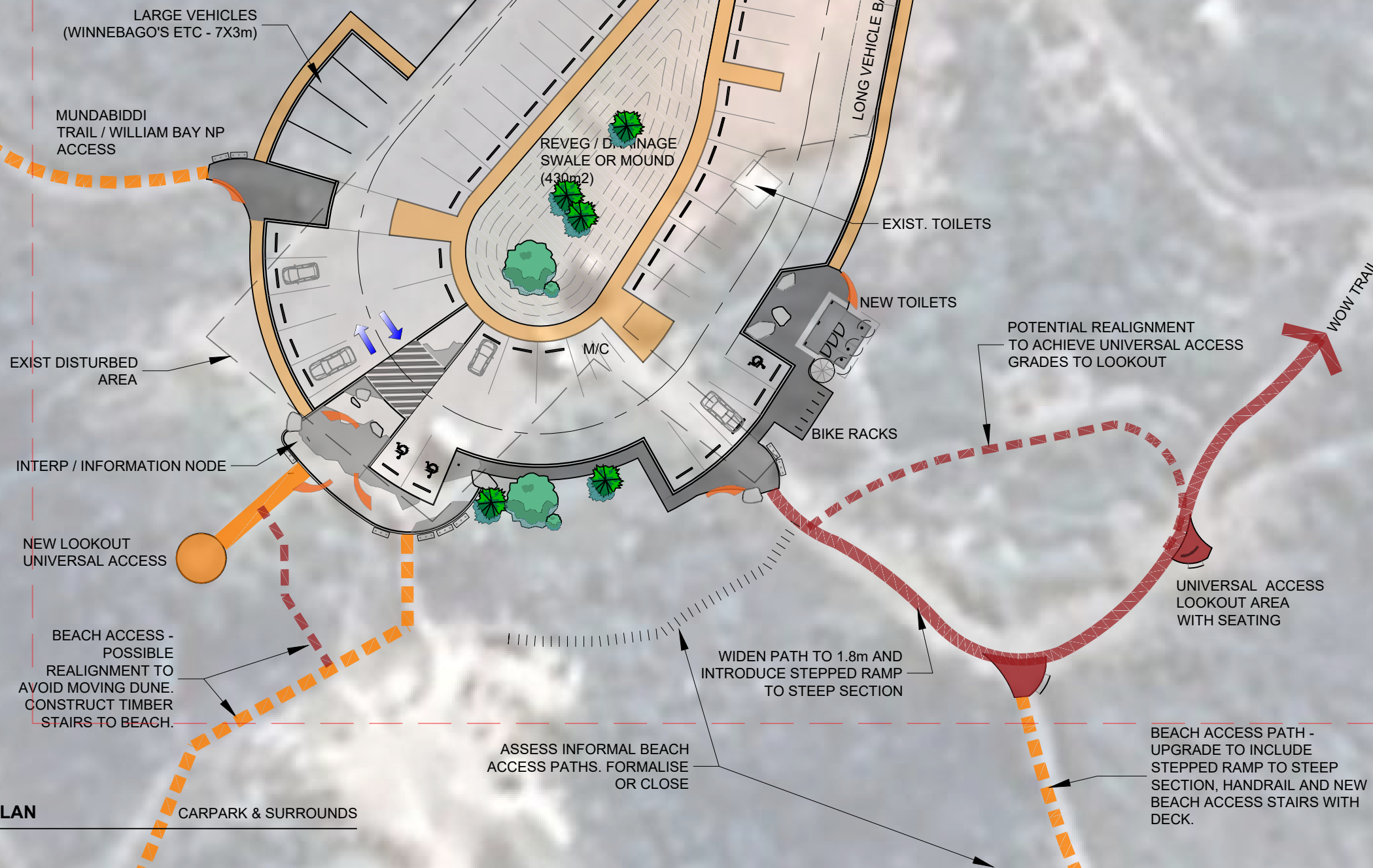

- PARKING CAPACITY**
- CARBAYS - 45
 - DISAB. BAYS - 3
 - LONG VEHICLE - 3
 - WINNEBAGO'S - 4
 - M/C - 4

03 CONCEPT PLAN
 1:500 (A3)

3 OF 6
 JUNE 2020

DRAFT
 FOR DISCUSSION ONLY



Prepared for the
 Shire of Denmark

LIGHTS BEACH REDEVELOPMENT
 concept plan

DRUM
 landscape architecture

Doug Simpson
 0434 229 122 / dougdrum68@gmail.com

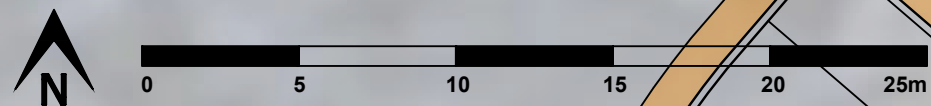

SIGNAGE INCLUDING INFORMATION ON THE NATIONAL PARK BOUNDARIES, DOG AREAS & MUNDABIDDI TRAIL

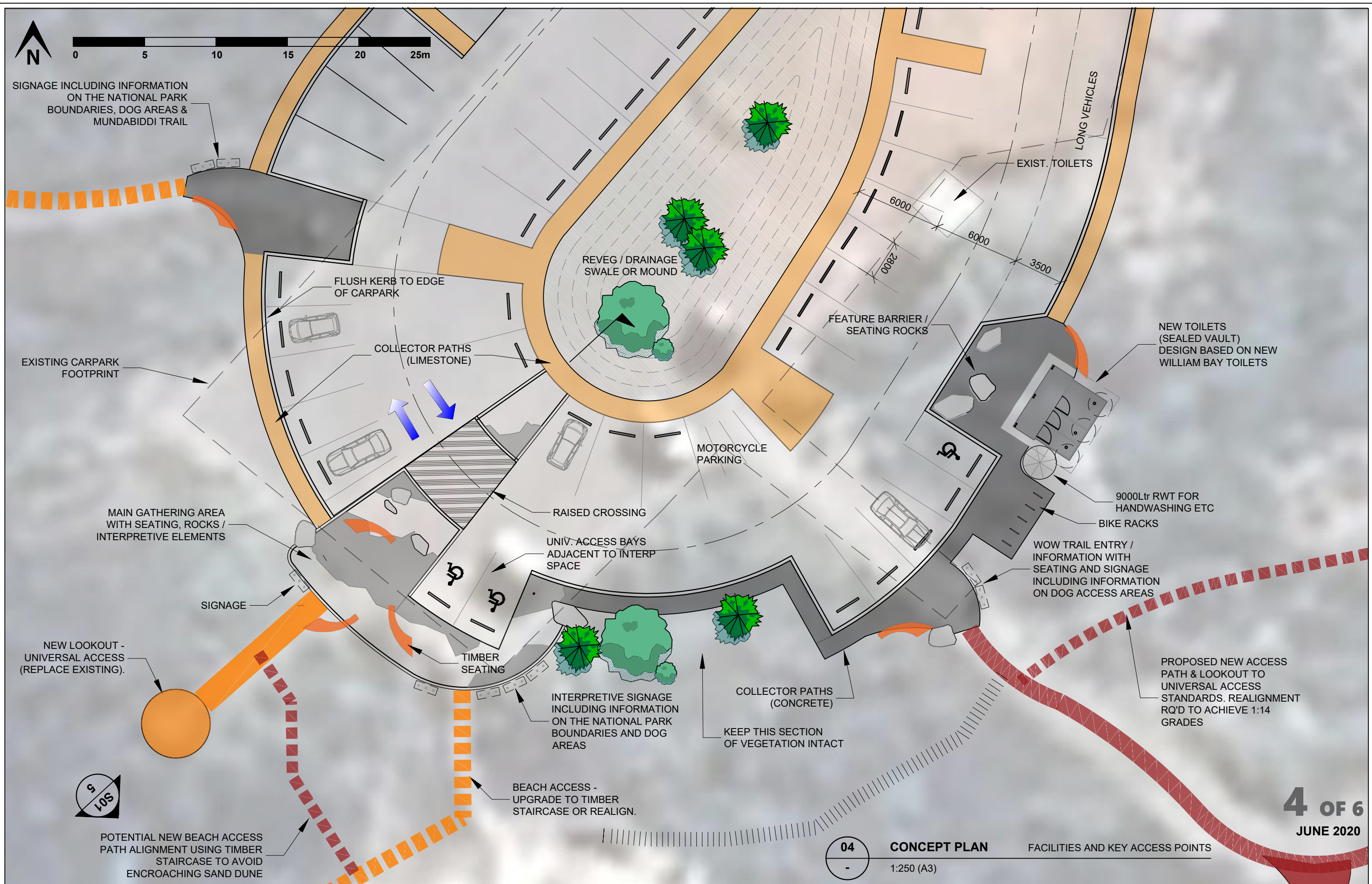

4 OF 6
JUNE 2020

04 CONCEPT PLAN FACILITIES AND KEY ACCESS POINTS
1:250 (A3)

DRAFT
FOR DISCUSSION ONLY



Prepared for the
Shire of Denmark

LIGHTS BEACH REDEVELOPMENT
concept plan

DRUM
landscape architecture

Doug Simpson
0434 229 122 / dougdrum68@gmail.com



Google Earth
image © 2020 CNES / Airbus



Google Earth
image © 2020 CNES / Airbus



Google Earth
image © 2020 CNES / Airbus



Google Earth
image © 2020 CNES / Airbus

S01
4

SECTION

CARPARK & GATHERING AREA

NTS



5 OF 6
JUNE 2020

DRAFT
FOR DISCUSSION

Prepared for the
Shire of Denmark



LIGHTS BEACH REDEVELOPMENT
concept plan - photo montage

DRUM
landscape architecture

Doug Simpson
0434 229 122 / dougdrum68@gmail.com



LOOKOUTS / DECKS / FURNITURE

PARKING / PATHS



SIGNAGE / INTERP

TOILETS

EXAMPLES OF FACILITIES

DRAFT
FOR DISCUSSION

Prepared for the
Shire of Denmark



LIGHTS BEACH REDEVELOPMENT
concept plan

DRUM
landscape architecture

Doug Simpson
0434 229 122 / dougdrum68@gmail.com

SCHEDULE OF SUBMISSIONS

‘Lights Beach Concept Plan’

Submissions Received from Public

Name & Address Details	Verbatim Submission
[REDACTED]	<p>1 We live in the Ocean Beach area and visit Lights Beach up to 3-5 days a week year round, for dog walking, swimming or surfing etc We feel that the proposed development concept plan is totally unnecessary at this point in time, and that there is more than ample parking, access and adequate toilet facilities already in place. The position of the proposed long vehicle parking bays, will require damaging, removing and encroaching on the existing flora covering the dune system to the west, as will the massive car park expansion and bays to the north, along with the proposed pedestrian pathways connecting the Munda Bididi trail and WOW Trail. Only once in the last three years would we have seen the car park at capacity, and this was before the recent expansion which has already taken place, and already allows for long vehicle parking. The proposed timber platform down on the beach to the east, is going to be anchored to the existing rock? This seems invasive & unnecessary also, and will not necessarily provide a “consistent descent” onto the beach depending what the swell, storm action and sand movement does, as this changes daily. The ongoing cost of maintenance to the shire for all of this new infrastructure, sealed car parks, toilets, landscaping, pathways & wooden platform is another consideration.. In a town where we “can’t afford” a pool, or a Youth Centre for our young people, this seems to be an unnecessary “over investment” at this point. Let Lights Beach remain as is.. accessible, yet with it’s beautiful untamed wildness intact. We do not need to “tame” and over develop every inch of this beautiful, amazing and wild south coast. Point Ann springs to mind as another example of “over spending” and unnecessary invasive premature development. I’m sure there are more pressing and important issues and needs within the community, for the Shire to be spending their time, energy and expertise on.</p>
[REDACTED]	<p>2 As one of the Community members on the Committee I was disappointed to see a number of facets missing from the Plan. The points that I will make have all been discussed and agreed (and minuted) at our committee meetings. One can argue that the Plan is a DRAFT, but unless these points are made and recorded they could well be forgotten, see below.</p> <ul style="list-style-type: none"> • The National Park Boundary should be shown. The Car parking area is provided to service BOTH the Shire facilities and those of William Bay National Park. That was why a representative of Parks & Wildlife was on the committee. The Parks representative was in agreement with the following comments. • Dogs. Currently there is no clear message to visitors (including locals) that the National Park is to the west, and the Shire’s facilities are to the east; that dogs are permitted to run freely on the beaches to the east, but are NOT permitted within the National Park to the west. Signage is so important, because unless it is properly positioned and that the use of the WHOLE area is explained we will return to the current situation where dogs are taken into the National Park, into an area the Hooded Plovers nest and breed. There are no shorebirds along Lights Beach, simply because it is a dog exercise area. The Hooded Plover is classed VULNERABLE, ie its population is decreasing. • One of the reasons why the public walk their dogs into the National Park is because the National Park signage is beyond the carpark area. Signage is needed at the very beginning of the path leading to the Park to say “NO DOGS, this path leads ONLY to the National Park”, or words to that effect. • The comments I made at our meetings about signage at the carpark area apply equally to the beach. Parks & Wildlife officers agreed that their signage is also needed on the beach. The Shire should also put a sign on the beach (above the storm surge level), stating NO DOGS beyond this point. I’m happy to be involved in determining the signage required. • Signage is needed on the road from a safety perspective. In fact, if money allowed, the crest of the hill just before the carpark (coming from Lights Rd) should be removed. Currently this is a hazardous “junction”. There was a question of the status of the road, and responsibility for its upgrade. This is a simple engineering exercise, • Perhaps highlight the provision of racks for bikes, as time goes on and with the tracks available along this section of coast bike racks are far more important now than before, and e-bikes make the journey more viable for older people. <p>If there is a reluctance to put all of these points on the drawing, then put them down in note form, excepting the ones relating to the need to show the National Park. There is no reason why the Shire should not put up their signs now, at the carpark and on the beach re DOGS, minimal cost, and the right thing to do. The Birdlife annual bird surveys show Hooded Plovers nesting at the westerly beach, I undertook the last survey and there was a family there.</p>
[REDACTED]	<p>3 1. Its not adequately clear that the west side of the works, where the Bib Track & Mudda Bididi leads off, that it is National Park. More prominent signage is essential to deal with this. 2. Much more prominent keep dogs out signs are needed (possibly by signage drilled into the granite at beach level) to help stop dogs being taken into the National Park via the beach as happens frequently. The drilling into one of the granite shelves would preserve the signage from washing away in big storms. 3. Please reconsider the adequacy of bike rack facilities - a lot more bikes are used down there due to the WOW trail and Mudda Bididi - bikers need the racks available, otherwise some dump bikes on the native vegetation so degrading the area.</p>
[REDACTED]	<p>4 With regard to the above Plan, I am concerned that signage (warning people of entering National Park and thus no dogs allowed) needs to be put in place at the western end of the beach before the steps down and also on the granite rocks. My concern for such signage is that at the western area, which is National Park, is easily accessed by people who have visited Lights Beach with their dogs on the eastern (Shire) side of Lights Beach. The western area's stream is the endangered hooded plovers' beach nesting area. I myself have seen adult birds with chicks and juveniles in and around this stream. Even if the Lights Beach Development Concept Plan is delayed, I strongly feel that signage needs to be put in place now to help protect our wildlife.</p>
[REDACTED]	<p>5 I am writing re the above plan for Lights Beach. With the increase in parking enabling more visitors and locals to this beach I am concerned that as the eastern side is already a much used dog beach that without strict signage protecting the western side going into the National Park there will be more dogs taken into this area greatly disturbing the wildlife there. I have been doing bird surveys for the last 20 years over all of Lights Beach and there has been a steep decline of the endangered beach nesting Hooded plover.</p>

SCHEDULE OF SUBMISSIONS

'Lights Beach Concept Plan'

Submissions Received from Public	
Name & Address Details	Verbatim Submission
	<p>The only area in the last few years I have seen adult birds with chicks and juveniles is around the stream in the National Park. I have often found people with dogs in this area who have come along the beach in front of the carpark and walked around the rocks into the National Park. They say that there is no sign down on the beach advising them that they are entering the National park where dogs are prohibited. I feel that signage is needed before the steps down and also on the granite rocks to the western end of the beach. Even if this development plan is delayed I think signage needs to be put in place now to help protect our wildlife.</p>
	<p>6 Whilst acknowledging this plan is still in draft form, it is difficult to make constructive comment because of a lack of detail in the definition of how the spaces should be used for recreation. Our main issue is signage, or lack of it in the draft plan. Without clear signs strategically placed, there is bound to confusion about where people should go resulting in misuse of the particular space and angst from other users. This occurs currently. In particular there should be signs for : * Demarcation of the national park boundary showing that dogs are prohibited within the park. * Indicating that dogs are only permitted on the eastern beach, NOT on the western side. * In both cases above more than one sign is needed to get the message across. Car Parking Provision Although the car park appears to have several vegetation plots at the ends and through the centre, the visual amenity would be considerably improved by breaking up the car bays further into user friendly smaller blocks with greater use of local native vegetation to separate them.</p>
	<p>7 *Why make the carpark bigger (LH explained reasoning behind this) *Please extend the beach to get to back beach easier by creating a path over the B14 headland *make room for a coffee van</p>
	<p>8 I'm happy to read through facebook about the development project at Lights Beach. If budget permits, I think that some shaded areas on the beach and disable access would also be welcome.</p>
	<p>9 I have read the above plan and write in favour of this. Carpark upgrades are sorely required here and this plan covers both the parking and environmental considerations needed. I am strongly in favor of this.</p>
	<p>10 I would like to mention that I find the size of the car bays are way too small for 4wd and people trying to get dogs or children or older folks out of the car if there's another car next to them, maybe it might work in the city with less tourists and 4wds and may squeeze an extra car in the car park but I think you might find a lot of people have difficulties. This also occurs at agi where there's a slope as well!</p>
	<p>11 LongVehicleParking-vegetation will need to be cleared. Banks will need stablising or degree of slope lessened by clearing further. Car-Park- Where is the need for so many parking bays? Utilise existing cleared area for parking. Lookout- No need to change existing lookout, already functional. Platform at base of steps unnecessary, will impact on natural features(granite rock). Sand will shift and step down to sand will always change. Where is money for this project coming from? To use Drought Assistance funding would not be aoproppiate.</p>
Denmark Weed Action Group	<p>12 CAR-PARK- Use already cleared area for parking. Long vehicle parking will impact native vegetation. Is there a need for so many parking bays? LOOKOUT- No need for new lookout, existing one is functional. Keep signage to a minimum. PLATFORM at base of steps will have no advantage over what is already there. It will detract from the natural beauty of the granite rocks. The sand will always shift and there will never be a consistent height to step down from. FUNDING- To use Drought Relief funds would be inapropriate.</p>
	<p>13 I understand that some upgrade is needed at Lights Beach, however in a much smaller scale, due to the following: Why would you put Caravan Parking Bay when Lights Road goes from Tar to a one lane Narrow Dirt Road, which be used by Caravaners as a possible short cut to Williams Bay. People already sleep there overnight, and this would impact more with Caravans. There is no need to fix the steps when they work fine as they are -steps are needed at Ocean Beach Lookout car part to beach. There is currently no control by dog owners in the car park and on the beach, not on leads, and many people with more than 2 dogs per responsible adult. People are taking their dogs in the National Park beach also, which could lead to confrontation between groups as has happened in William Bay! Non-dog owners, are unable to enjoy Lights Beach without always being hassled by dogs in large groups. Maybe a time frame should be introduced for Dog Exercise i.e. before 8.30 and after 3.30 so non-dog owners can also enjoy the beach. I have been a property owner on Lights Road since 1990, and believe a review of the 1979 Dog Act is needed to make it cope with the population growth that Denmark has had, as this small and once beautiful beach is slowly being destroyed and many locals without dogs, now do not use it at all.</p>
	<p>14 I'm emailing re the Lights Beach Concept Plan and passing on the views of my friends, all of whom are locals and spend a lot of time at our beaches, especially Oceans, Lights, Williams, Parrys as well as Shelley and further afield. Upon immediate consultation, most comments have been in like the car park as it is', 'it doesn't need fixing' or 'is rather council money be spent on ____'. These concerns should not be swept aside lightly. However, most also agree that the car park is in dire need of repair and support renewal but are concerned about a few main things.</p>

SCHEDULE OF SUBMISSIONS

'Lights Beach Concept Plan'

Submissions Received from Public	
Name & Address Details	Verbatim Submission
	<p>1. Lights is the locals beach. It is the nudie beach and a surfers beach. It is concerning to most that this beach is being paved for the purpose of feeding into the 'amazing south coast' 'branding and imagery' and that the concept plan is grey and bleak and (perhaps unintentionally) morphing every coastal destination from The Gap to Parry's into a uniform unimaginative grey-nomadesque and sterile car park. It looks like a deliberate move to milk the tourist trail, and as it is, that's even more reason to make this car park at Lights unique and not just another stop for the caravan.</p> <p>2. Denmark is unique. And we need to find our own identity within the amazing south coast imagery and this does not meet that requirement. Some feedback has focussed on including a Labyrinth for mindfulness (and yoga above the coastal panorama) and creative community input. There was plenty of support for a local creative collaboration with meaningful say and consultation and not just a token artwork in the corner somewhere.</p> <p>3. The car park traffic flow (arrows) has cars making a 'blind turn' towards the SW corner of the car park where the Munda biddi trail is and arguably, one of the busiest places for pedestrians. It then feeds back into the main line. It would be better if traffic fed into the left and then made a right turn away from the path.</p> <p>4. anyone that's been to Lights knows that it's a locals beach where people pull up, unload, and cut across to one of the two entrances. This car park has little evidence of taking into account how the car park is actually physically utilised by regular beach-goers. There is little boot-popping room for manoeuvre in the centre and no walk ways through the middle. People will not walk all the long way round just because it's a nice footpath around the edge.</p> <p>5. Add some colour.</p> <p>6. The boardwalk is supported. But doesn't mention fixing the other western wooden wall way. Which is broken and not just high like the eastern one.</p> <p>7. The wooden benches do not look attractive nor comfortable. Most hope they are indicative only.</p> <p>8. An emphasis on ensuring noongar names are more prominent with English names and local colloquialisms included.</p> <p>9. Way more whimsy (that's my personal suggestion).</p> <p>I hope you take these views into consideration, they are the opinion of quite a few locals.</p>
E	<p>15 My submission is mainly to do with the carpark,</p> <ol style="list-style-type: none"> 1. My orientation is to 'keep it simple', keep the entire area low key, which is consistent with the Plan. 2. The key issue with vegetation is the vegetation in/on the surrounding landscape, including protecting native vegetation. This is habitat as well as amenity. 3. I'm certainly pleased to see the traffic flow being improved and following the 'driving on the left' pattern. 4. I think that plantings in the middle of the carpark are a waste of time as people movements to and from vehicles will undoubtedly damage any plants 'in the way'. 5. Consistent with the above point about plantings, there should be no curbs 6. One of the positive aspects of the current carpark is the ability to drive through from one side to the other of the central spaces; there are no curbs or bushes to impede free vehicle movement. 7. All vehicle parking spaces should allow for reversing into the space, partly as some users prefer to have access to the rear of their vehicle without being in danger from passing vehicles. This could be access to rear compartments, such as the boot, that allow access by adults and children in a way that has them out of the roadway. 8. Having centre carparking spaces as now allows drivers to park with a trailer in a way that allows a 'drive thru' approach. The Concept Plan shows a side parking area for long vehicles which can be very hard to access with a trailer. That said, long caravans will be a problem whatever is done by way of design.
	<p>16 1. Sacrifice two bays each row to form planted islands PI1 & PI2 otherwise it is a long unbroken area/row of bays. 2. Secondary path to beach - surfers view point. Form into a path otherwise they will degrade this overland route. 3. Make up bays at the entry if necessary.</p>

